

DHX 27 5/8-KFZ

Log.-periodic "5/8" Helical Mobile Antenna for the 27 MHz CB-Band

DESCRIPTION

- 0.9 m high top-quality antenna with high efficiency.
- Stainless steel Z-mount with ball-joint and wing screw whip-fastening system.
- Despite the very small physical dimensions, the toploading and the log.-periodic distance between the helical windings yield exceptionally good performance.
- Simple mounting with access from the outside only. Models with roof thickness from 2 mm to 7.5 mm mounting from the inside.
- Choice between two connection principles:
 - Z-mount : FME-connection (FME-cable to be ordered separately).
 - ZP4-mount : Permanently attached 4 m RG 58 cable terminated with FME-connector.



MOUNTING

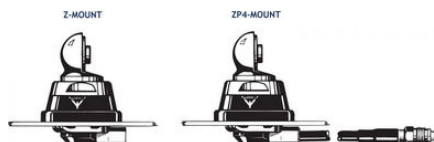

ORDERING DESIGNATIONS

TYPE	PRODUCT NO.	MOUNT VERSION
DHX 27 5/8-KFZ	130000593	Z-mount with FME-system
DHX 27 5/8-KFZP4	130000594	ZP4-mount with 4 m cable and FME connector

SPECIFICATIONS

ELECTRICAL	
MODEL	DHX 27 5/8-KFZ
ANTENNA TYPE	Log.-periodically wound helical mobile antenna
FREQUENCY	27 MHz CB-band
IMPEDANCE	Nom. 50 Ω
POLARIZATION	Vertical
BANDWIDTH	≥ 500 kHz @ SWR ≤ 2.0
MAX. POWER	200 W
MECHANICAL	
MATERIALS	Whip: Copper-wire wound on glass fiber, covered by polyethylene Chromed brass Mount: Chromed brass Weather- and shockproof plastics Stainless steel
RECOMMENDED INSTALLATION TORQUE	7.5 \pm 1 Nm
COLOUR	Bright/black
HEIGHT	Approx. 0.9 m
WEIGHT	Z-mount: Approx. 210 g ZP4-mount: Approx. 370 g
MOUNTING	$\varnothing 21$ mm dia. hole (For roof thickness 2 mm up to 7.5 mm mounting hole should be $\varnothing 22$ mm dia.)
ROOF THICKNESS	Max. 2.0 mm (Models up to 7.5 mm on request)

INSTALLATION

This antenna is supplied with type Z-mount. The whip is fastened to the mount by means of our standard ball-joint and wing screw system. The adjustable ball-joint ensures that the whip can always be mounted in a vertical position independent of the angle of the installation spot.

The Z-mount is particularly well suited for mounting on car-roofs because of its ability to be installed exclusively with access from the outside. The Z-Mount for roof thickness from 2 mm to 7.5 mm must be mounted from the inside. However, the antenna can be installed anywhere on the car, as the Z-mount is equally well suited for mounting on e.g. trunk or wing.

INSTALLATION DIMENSIONS

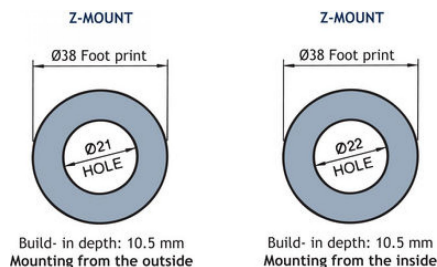

INSTALLATION STEPS

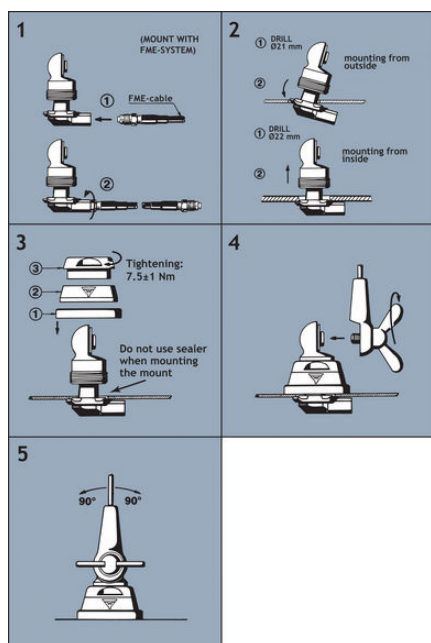

Do not use sealer on rubber gasket or other places.

TUNING

The antenna must be tuned using SWR-meter. Unfasten the union nut at the top end of the whip and pull out the adjusting pin approx. 1 cm at a time until best possible SWR is obtained. Re-fasten the union nut thoroughly.



PROCOM France S.A.R.L. se réserve le droit d'améliorer les spécifications sans préavis.

27/03/14