

ML 3-XR

¼ λ Mobile Antenna for the 80 MHz Band

DESCRIPTION

- Black-chromed, conical stainless steel whip with shock spring.
- Whip design for optimum wind noise reduction.
- Elegant transition between whip and mounting surface due to slim-line mount.
- 30° tiltable whip.
- Ideal for installation on the narrow strip on rear wing between trunk lid and side of car.
- Stainless steel X-mount with M6-thread whip-fastening system.
- Simple mounting exclusively with access from the outside.
- Models available with X-mount (oblong) and CX-mount (circular).
- Choice between two connection principles:
 - X-mount: FME-connection (supplied without cable).
 - XP4-mount: Permanently attached 4 m cable terminated with FME-connector.

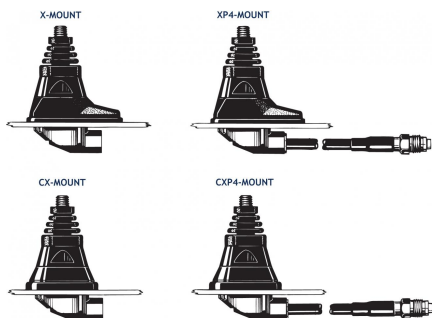

ORDERING DESIGNATIONS

TYPE	PRODUCT NO.	MOUNT VERSION
ML 3-XR	130001457	X-mount (oblong) with FME-system
ML 3-CXR	130000652	CX-mount with FME-system (circular)
ML 3-XP4R	130001339	XP4-mount with 4 m cable and FME-connector (oblong)
ML 3-CXP4R	130001435	CXP4-mount with 4 m cable and FME-connector (circular)

SPECIFICATIONS

ELECTRICAL	
MODEL	ML 3-XR
ANTENNA TYPE	¼ λ mobile whip antenna
FREQUENCY	Tunable by cutting within: 66...88 MHz (Also applicable: 88...175 MHz)
IMPEDANCE	Nom. 50 Ω
POLARIZATION	Vertical
GAIN	0 dB (acc. to EIA RS-329-1)
BANDWIDTH	≥ 8 MHz @ SWR ≤ 2.0
SWR	≤ 1.3 @ f. res.
MAX. POWER	250 W
MECHANICAL	
MATERIALS	Whip: Black-chromed, conical stainless steel Black-chromed brass Mount: Black-chromed brass Weather- and shockproof plastics Stainless steel
RECOMMENDED INSTALLATION TORQUE	4 ± 1 Nm
COLOUR	Black
HEIGHT	Approx. 1.1 m (dep. on freq.)
WEIGHT	X-version: Approx. 110 g XP4-version: Approx. 270 g
MOUNTING	18 mm dia. hole

INSTALLATION

This antenna can be mounted anywhere on the vehicle.

The oblong X-mount is especially suited for mounting on the often very narrow strip on the rear wing between the trunk lid and the side of the car.

Mounting can take place exclusively with access from the outside when drilling an 18 mm dia. hole. Mounting can take place from the inside by drilling a 14 mm dia. hole. When mounting in a 14 mm dia. hole, remove the bottom plastic ring of the packing gasket with a sharp cutter.

When cleaning the car in car-washing machines, remove the whip using a spanner, size 9 mm. After wash, refit the whip and tighten it lightly with the spanner.

As the mount is internally equipped with a bendable section, the antenna can always be adjusted to an upright position independent of the tilt angle of the installation spot (up to 30° tilt).

2. INSTALLATION STEPS

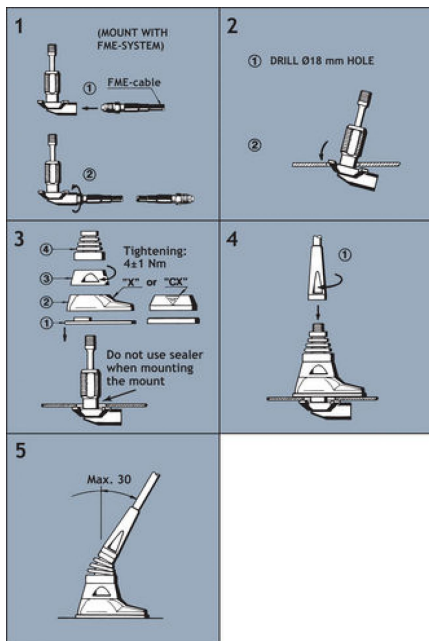

Do not use sealer on rubber gasket or other places.

3. TUNING

The antenna should always be tuned using an SWR-meter. The cutting diagrams below serve as a guide for this procedure.

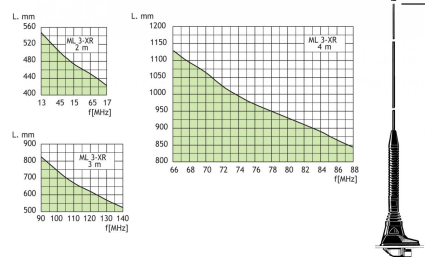

PROCOM France S.A.R.L. se réserve le droit d'améliorer les spécifications sans préavis.

28/03/11