

MU 3-BZ/TETRA/I

3 dB Gain 5/8 λ Mobile Antenna for the TETRA Band

DESCRIPTION

- Black-chromed stainless steel whip with toggle joint.
- Factory tuned for the range 380 - 410 MHz.
- Stainless steel BZ-mount with ball-joint and wing screw whip-fastening system.
- Simple mounting exclusively with access from the outside. Models with roof thickness from 2 mm to 7.5 mm mounting from the inside.
- Choice between two connection principles: BZ-mount: FME-connection (supplied without cable).
- BZP4-mount: Permanently attached 4 m cable terminated with FME-connector.



Hat screw option:

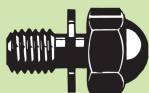

For antenna delivered with hat screw instead of wing screw add a K to the antenna designation.

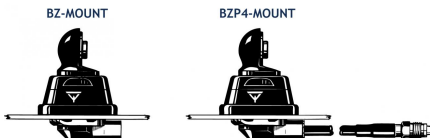

ORDERING DESIGNATIONS

TYPE	MOUNT VERSION	PRODUCT NO.
MU 3-BZ/TETRA/I	BZ-mount with FME-system	130001374
MU 3-BZP4/TETRA/I	BZP4-mount with 4 m cable and FME-connector	130001389

SPECIFICATIONS

ELECTRICAL	
MODEL	MU 3-BZ/TETRA/I
ANTENNA TYPE	5/8 λ mobile whip antenna
FREQUENCY	380 - 410 MHz
IMPEDANCE	Nom. 50 Ω
POLARIZATION	Vertical
GAIN	Approx. 3 dB (acc. to EIA RS-329-1)
BANDWIDTH	≥ 10 MHz @ SWR ≤ 2.0 ≥ 30 MHz @ SWR ≤ 3.0
SWR	≤ 1.5 @ f. res.
MAX. POWER	100 W
MECHANICAL	
MATERIALS	Whip: Stainless steel, black-chromed Black-chromed brass Mount: Black-chromed brass Weather- and shockproof plastics Stainless steel
RECOMMENDED INSTALLATION TORQUE	7.5 ± 1 Nm
COLOUR	Black
HEIGHT	Approx. 49 cm
WEIGHT	BZ-version: Approx. 140 g BZP4-version: Approx. 280 g
MOUNTING	ø21 mm dia. hole (For roof thickness from 2 mm up to 7.5 mm mounting hole should be ø22 mm dia.)
ROOF THICKNESS	Max. 2.0 mm (Models up to 7.5 mm on request)

TYPICAL SWR CURVE

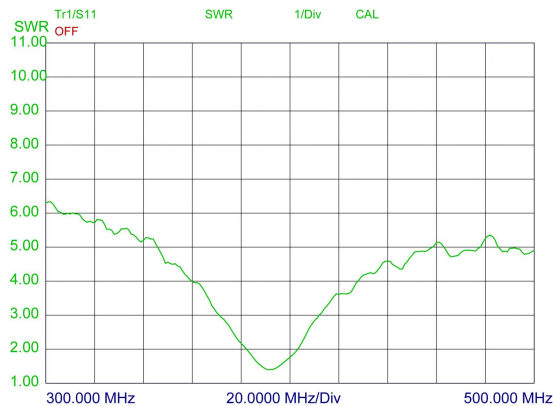

INSTALLATION

This antenna is provided with type BZ-mount. The whip is fastened to the mount by means of our standard ball-joint and wing screw system. The adjustable ball-joint ensures that the whip can always be mounted in a vertical position independent of the angle of the installation spot.

The BZ-mount is particularly well suited for mounting on car-roofs because of its ability to be installed exclusively with access from the outside. The BZ-Mount for roof thickness from 2 mm to 7.5 mm must be mounted from the inside.

However, the antenna can be installed anywhere on the car, as the BZ-mount is equally well suited for mounting on e.g. trunk or wing.

1. INSTALLATION DIMENSIONS

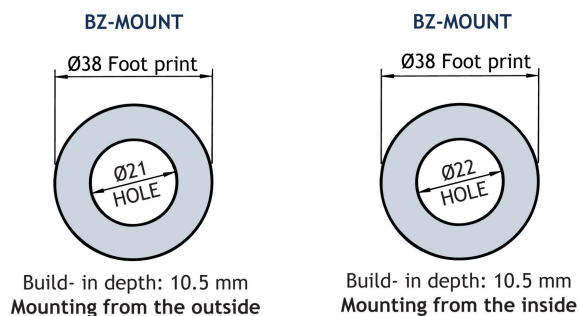

2. INSTALLATION STEPS

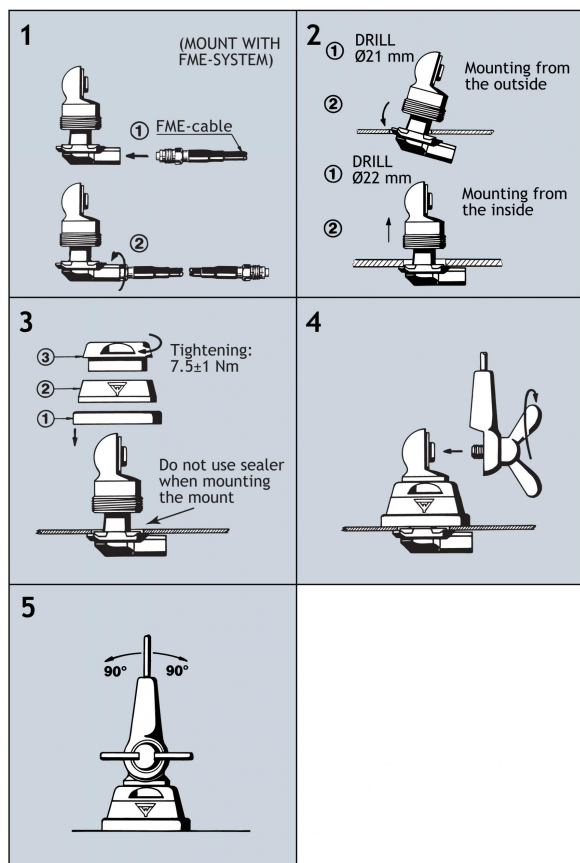

Do not use sealer on rubber gasket or other places.



PROCOM France S.A.R.L. se réserve le droit d'améliorer les spécifications sans préavis.

15/12/14