

MU 807-XG/...

Unity Gain $\frac{1}{4}$ λ Mobile Antenna for the 800 MHz band with GPS

DESCRIPTION

- External antenna whip mounted on the XG-COMBI mount.
 - Silicone covered flexible steel wire whip.
 - Two models:
 - MU 807-XG/l: 768 - 806 MHz
 - MU 807-XG/h: 806 - 869 MHz
 - Stainless steel XG-COMBI mount with M6-thread whip-fastening system.
 - Choose between mount with FME-connection (without cable) or model with permanently attached 4 m cable with FME connector.
 - Easily removable whip for car wash.
- GPS-antenna for fixed installations.
 - Full hemispherical coverage.
 - Built-in high-gain, low-noise amplifier.
 - Right-Hand Circular Polarization (RHCP).
 - 2.85 V - 5 V supply voltage (typical 3 V).



All whips are compatible with all mounts.

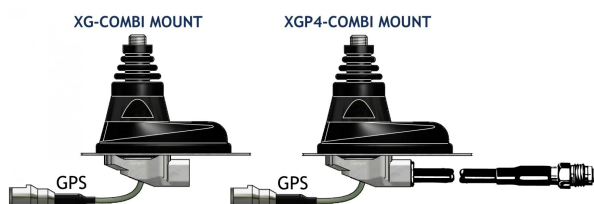

ORDERING DESIGNATIONS

TYPE	FREQUENCY	MOUNT VERSION	PRODUCT NO.
MU 807-XG/l	768 - 806 MHz	XG-COMBI mount (oblong) with FME-system	130002081
MU 807-XG/h	806 - 869 MHz	Same mount as above	130002082
MU 807-XGP4/l	768 - 806 MHz	XGP4-COMBI mount (oblong) with 4 m cable + FME-system	130002083
MU 807-XGP4/h	806 - 869 MHz	Same mount as above	130002084

SPECIFICATIONS

ELECTRICAL	
MODEL	MU 807-XG/...
ANTENNA TYPE	$\frac{1}{4}$ λ mobile antenna
FREQUENCY	800 MHz-band covered by two models
IMPEDANCE	Nom. 50 Ω
POLARIZATION	Vertical
GAIN	0 dB (acc. to EIA RS-329-1)
BANDWIDTH	> 80 MHz @ SWR \leq 1.5 > 140 MHz @ SWR \leq 2.0
SWR	\leq 1.2 @ f. res.
MAX. POWER	60 W
MECHANICAL	
MATERIALS	Whip: Steel wire covered with silicone tubing Black-chromed brass Mount: Black-chromed brass Weather- and shockproof plastics Stainless steel
RECOMMENDED INSTALLATION TORQUE	4 \pm 1 Nm
COLOUR	Black
HEIGHT	Approx. 100 mm
WEIGHT	XG-version: Approx. 70 g XGP4-version: Approx. 210 g
MOUNTING	19 mm dia. hole
ELECTRICAL FOR GPS-PART	
OPERATING FREQUENCY	1575.42 \pm 1.023 MHz
LNA GAIN	22 dB \pm 2 dB
NOISE FIGURE	Max. 1.5 dB (typical 1.1 dB)
VOLTAGE	DC 2.85 V \sim 5 V (typical 3 V)
CURRENT	\leq 20 mA
IMPEDANCE	Nom. 50 Ω
MECHANICAL	
CONNECTOR	Cable: RG 178, length 150 mm Connector: FME-male

INSTALLATION

The XG-antenna types can be mounted anywhere on the car, however, roof top mounting is always recommended.

The oblong XG-COMBI mount can be mounted on the often very narrow strip on the rear wing between the hatch and the side of the car.

Mounting can take place with access from the outside or inside when drilling an 19 mm dia. hole.

When cleaning the car in car-washing machines, remove the whip using a spanner, size 9 mm. After wash, refit the whip and tighten it lightly with the spanner.

As the XG-COMBI mount is internally equipped with a bendable section, the antenna can always be adjusted to an upright position independent of the tilt angle of the installation spot.

1. INSTALLATION DIMENSIONS

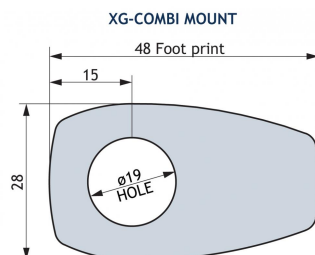

2. INSTALLATION STEPS

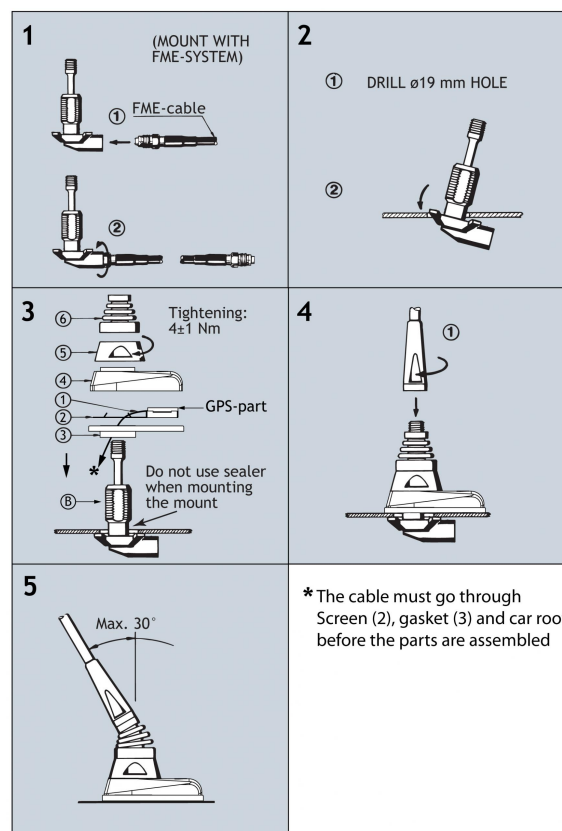

Do not use sealer on rubber gasket or other places.

ASSEMBLY INSTRUCTIONS

1. Put GPS-FME-connector-cable through the gasket (2).
2. Put the gasket (2) + GPS-part (1) over the body (B).
3. Put the body (B) + gasket (3) + GPS-part (1) through the Ø19 mm hole.
4. Put the housing (4) over the body (B) and be sure that the GPS-part (1) fits into the square hole in the body (B).
5. Put the threaded part over the body (B) and tighten max. 4 ±1 Nm!.
6. Put the corrugated plastic unit (6) over the body (B).
7. Mount the antenna whip se figure 4.



PROCOM France S.A.R.L. se réserve le droit d'améliorer les spécifications sans préavis.

25/06/14