

MU 911-ZG/...

Collinear 4 dB Mobile Antenna for the 900 MHz Band

DESCRIPTION

- Encapsulated phasing coil.
- Black-chromed stainless steel whip.
- 3 models, type "l", "m" and "h" cover band segments suiting the most common 900 MHz CELLULAR networks such as EAMPS, ETACS, NMT-900 and EGSM.
- Stainless steel ZG-mount with M8 x 1-thread whip-fastening system.
- Simple mounting exclusively with access from the outside.
- Choice between two connection principles:
 - ZG-mount: FME-connection (supplied without cable).
 - ZGP4-mount: Permanently attached 4 m low loss cable terminated with FME-connector.



ZG-MOUNT

ZGP4-MOUNT

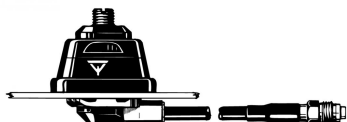

ORDERING DESIGNATIONS

TYPE	PRODUCT NO.	FREQUENCY	MOUNT VERSION
MU 911-ZG/l	130001248	824 - 894 MHz (EAMPS)	ZG-mount with FME
MU 911-ZG/m	130001250	872 - 950 MHz (ETACS)	
MU 911-ZG/h	130001246	880 - 960 MHz (EGSM&NMT-900)	
MU 911-ZGP4/l	130001249	824 - 894 MHz (EAMPS)	ZGP4-mount with 4 m cable and FME-connector
MU 911-ZGP4/m	130001251	872 - 950 MHz (ETACS)	
MU 911-ZGP4/h	130001247	880 - 960 MHz (EGSM&NMT-900)	

SPECIFICATIONS

ELECTRICAL	
MODEL	MU 911-ZG/...
ANTENNA TYPE	Colinear mobile antenna
FREQUENCY	900 MHz-band covered by three models
IMPEDANCE	Nom. 50 Ω
POLARIZATION	Vertical
GAIN	4 dB (acc. to EIA RS-329-1)
BANDWIDTH	≥ 50 MHz @ SWR ≤ 1.5 ≥ 90 MHz @ SWR ≤ 2.0
SWR	≤ 1.3 @ f. res.
MAX. POWER	60 W
MECHANICAL	
MATERIALS	Whip: Stainless steel and brass, black-chromed Mount: Black-chromed brass Weather- and shockproof plastics Stainless steel
RECOMMENDED INSTALLATION TORQUE	7.5 \pm 1 Nm
COLOUR	Black
HEIGHT	Approx. 35 cm
WEIGHT	ZG-version: Approx. 110 g ZGP4-version: Approx. 250 g
MOUNTING	21 mm dia. hole

INSTALLATION

This antenna should always be mounted on the car roof to ensure best omnidirectional coverage. The antenna is provided with our type ZG-mount for mounting from the outside in a 21 mm dia. hole.

The ZG-mount is provided with an M8 x 1 thread mount system. This construction meets the demand for a low-profile mobile mount with a slim appearance and with protection against theft of the antenna whip.

When cleaning the car in car-washing machines, the whip is easily removed using a spanner, size 12 mm. The whip is refitted again by screwing it onto the thread stud and tightening it with the spanner.

1. INSTALLATION DIMENSIONS:

ZG-MOUNT

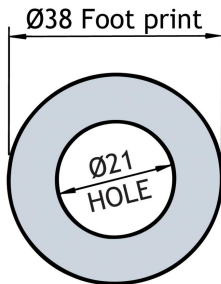

Build- in depth: 10.5 mm

2. INSTALLATION STEPS:

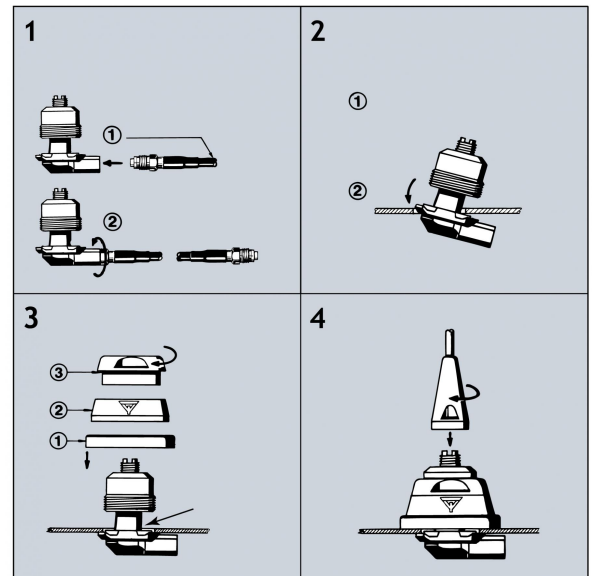

Do not use sealer on rubber gasket or other places.

3. TUNING:

The antenna is delivered factory-tuned and requires no further tuning.



PROCOM France S.A.R.L. se réserve le droit
d'améliorer les spécifications sans préavis.
14/12/11