

2 BNC Specifications

BNC Plug



BNC Jack



ELECTRICAL

Impedance	50 ohms	75 ohms
Frequency	DC to 4GHz	DC to 1GHz
VSWR	$1.35 + 0.01f(\text{GHz})$	$1.35 + 0.01f(\text{GHz})$
Insertion Loss	0.2dB Maximum @ 3GHz	0.2dB Maximum @ 1GHz
RF Leakage	-55dB Minimum @ 3GHz	-55dB Minimum @ 1GHz
Insulation Resistance	5Gohms Minimum	5Gohms Minimum
Inner Contact Resistance	1.5mohms Maximum	1.5mohms Maximum
Outer Contact Resistance	0.5mohms Maximum	0.5mohms Maximum
Working Voltage	500V RMS Maximum	500V RMS Maximum
Dielectric Withstanding Voltage	1500V RMS Maximum	1500V RMS Maximum

MECHANICAL

Durability	500 mating cycles	500 mating cycles
Cable Retention	equal to cable breaking strain	equal to cable breaking strain

ENVIRONMENTAL

Temperature Range	PTFE -65 to +165 deg C Delrin -55 to +85 deg C	PTFE -65 to +165 deg C Delrin -55 to +85 deg C
-------------------	---	---

MATERIALS

Bodies	Brass, Nickel Plated	Brass, Nickel Plated
Pins	Brass, Gold Plated	Brass, Gold Plated
Contacts	Phosphor Bronze, Gold Plated	Phosphor Bronze, Gold Plated
Ferrules	Brass, Nickel Plated	Brass, Nickel Plated
Insulators	PTFE or Delrin	PTFE or Delrin
End Caps	Brass, Nickel Plated	Brass, Nickel Plated
Gaskets	Silicon Rubber	Silicon Rubber
Springs	Steel, Nickel Plated	Steel, Nickel Plated
Panel Nuts	Brass, Nickel Plated	Brass, Nickel Plated
Panel Washers	Brass, Nickel Plated	Brass, Nickel Plated

All of the above products are manufactured in accordance with MIL-C-39012.

The above specifications are typical although some variations may occur.

EURO RADIO SYSTEM

Tél: +33 (0)1 39 31 28 00 Fax: +33 (0)1 39 31 27 00 E-Mail: commercial@ers.fr Site: www.ers.fr

BNC Cable Fixing 3

Crimp Plug

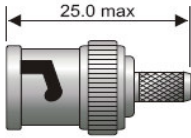

F1: Straight Ferrule



F2: Fluted Ferrule



F3: Fluted Ferrule with insulator



CRIMP HEX SIZES (ferrule / contact)

H1	3.25mm	0.72mm sq.
H2	4.52mm	1.69mm
H3	5.41mm	1.69mm
H4	6.48mm	1.69mm
H5	8.23mm	1.69mm
H6	10.90mm	2.54mm
H7	4.52mm	1.46mm
H8	3.83mm	0.72mm sq.
H13	5.18mm	1.46mm
H14	6.81mm	1.46mm

See pages 85-86 for application tooling

PART NUMBER	CABLE TYPE	FERRULE / STRIP DIMS / HEX SIZES		
		FERRULE	STRIP DIMS	HEX SIZES
BN15-8281-C06	Belden 8281	F1	B11	H5
BN15-2002-C06-2	BT2002	F1	B11	H13
BN15-2003-C06-2	BT2003	F1	B11	H14
BN15-3002-C06-2	BT3002, TZ75024	F1	B11	H7
BN15-0100-C06	CT100	F1	B11	H4
BN15-0125-C06	CT125	F1	B11	H5
BN15-M059-C06	Mini RG59, 62	F1	B11	H2
BN15-0012-C06	PSF1/2	F1	B11	H5
BN15-0013-C06	PSF1/3	F1	B11	H4
BN15-0017-C06	PSF1/7	F1	B11	H2
BN15-0017-C06-1	PSF1/7	F3	B12	H3
BN15-7000-C06-2	RA7000	F1	B12	H13
BN15-3002-C06	RD179	F1	B11	H2
BN15-D316-C06	RD316	F1	B11	H2
BN15-0011-C06	RG11	F1	B13	H6
BN15-0400-C06	RG142, 223, 400	F1	B11	H3
BN15-0174-C06	RG174, 188, 316	F2	B11	H2
BN15-0174-C06-1	RG174, 188, 316	F3	B12	H3
BN15-0178-C06	RG178, 196	F1	B11	H1
BN15-0179-C06	RG179, 187	F2	B11	H2
BN15-0179-C06-1	RG179PE, Triple Coax	F3	B12	H3
BN15-0213-C06	RG213, URM67	F1	B13	H6
BN15-0214-C06	RG214	F1	B13	H6
BN15-0058-C06	RG58, URM43	F1	B11	H3
BN15-0059-C06	RG59, 62, URM70	F1	B11	H4
BN15-0016-C06	Serial Digital Coax 4.5mm	F1	B11	H3
BN15-0026-C06	Serial Digital Coax, 6.8mm	F1	B11	H4

Strip Dimensions - see Illustration S.1

B11: A = 8.0mm B = 6.0mm C = 3.0mm

B12: A = 12.0mm B = 3.0mm C = 3.0mm

B13: A = 9.0mm B = 0mm C = 4.0mm

Illustration S.1

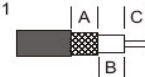

Plug to Plug Assemblies



PART NUMBER	CABLE TYPE	DETAILS	
CP6BCP6BB058-1000	RG58C/U, 1.0m	50 ohm	3GHz
CP6BCP6BB058-3000	RG58C/U, 3.0m	50 ohm	3GHz
CP6BCP6BB058-5000	RG58C/U, 5.0m	50 ohm	3GHz
CP6BCP6BB059-1000	RG59B/U, 1.0m	75 ohm	1GHz
CP6BCP6BB059-3000	RG59B/U, 3.0m	75 ohm	1GHz
CP6BCP6BB059-5000	RG59B/U, 5.0m	75 ohm	1GHz
CP6BCP6BB174-500	RG174A/U, 0.5m	50 ohm	1GHz
CP6BCP6BB174-1000	RG174A/U, 1.0m	50 ohm	1GHz
CP6BCP6BB179-500	RG179B/U, 0.5m	75 ohm	1GHz
CP6BCP6BB179-1000	RG179B/U, 1.0m	75 ohm	1GHz

EURO RADIO SYSTEM

Tél: +33 (0)1 39 31 28 00 Fax: +33 (0)1 39 31 27 00 E-Mail: commercial@ers.fr Site: www.ers.fr

4 BNC Cable Fixing

Crimp Right Angle Plug (solder contact)

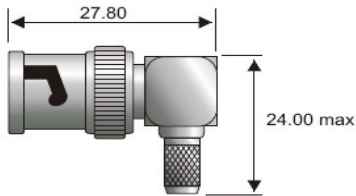

PART NUMBER	CABLE TYPE	FERRULE	STRIP DIMS	HEX SIZES
BN17-0013-C06	PSF1/3	F1	B14	H4
BN17-0017-C06-1	PSF1/7	F3	B16	H3
BN17-D179-C06	RD179	F1	B15	H1
BN17-D316-C06	RD316	F1	B15	H1
BN17-0400-C06	RG142, 223, 400	F1	B14	H3
BN17-0174-C06	RG174, 188, 316	F2	B15	H2
BN17-0174-C06-1	RG174, 188, 316	F3	B16	H3
BN17-0179-C06	RG179, 187	F2	B15	H1
BN17-0179-C06-1	RG179PE, Triple Coax	F3	B16	H3
BN17-0058-C06	RG58, URM43	F1	B14	H3
BN17-0059-C06	RG59, 62, URM70	F1	B14	H4

Strip Dimensions - see Illustration S.1

B14: A = 8.0mm B = 8.0mm C = 3.0mm

B15: A = 8.0mm B = 7.0mm C = 3.0mm

B16: A = 10.0mm B = 6.0mm C = 3.0mm

Crimp Jack

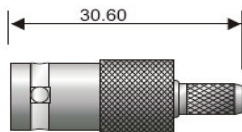

PART NUMBER	CABLE TYPE	FERRULE	STRIP DIMS	HEX SIZES
BN10-3002-C06-2	BT3002, TZC75024	F1	B17	H7
BN10-0013-C06	PSF1/3	F1	B17	H4
BN10-0017-C06	PSF1/7	F1	B17	H2
BN10-0017-C06-1	PSF1/7	F3	B12	H3
BN10-3002-C06	RD179	F1	B17	H2
BN10-D316-C06	RD316	F1	B17	H2
BN10-0400-C06	RG142, 223, 400	F1	B17	H3
BN10-0174-C06	RG174, 188, 316	F2	B17	H2
BN10-0174-C06-1	RG174, 188, 316	F3	B12	H3
BN10-0179-C06	RG179, 187	F2	B17	H2
BN10-0179-C06-1	RG179PE, Triple Coax	F3	B12	H3
BN10-0058-C06	RG58, URM43	F1	B17	H3
BN10-0059-C06	RG59, 62, URM70	F1	B17	H4

Strip Dimensions - see Illustration S.1

B12: A = 12.0mm B = 3.0mm C = 3.0mm

B17: A = 8.0mm B = 3.0mm C = 3.0mm

Crimp Bulkhead Jack - Hex Flange

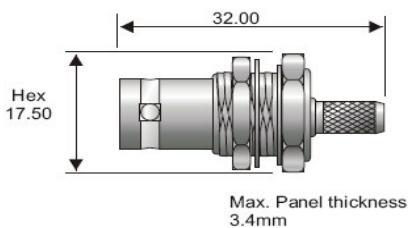

PART NUMBER	CABLE TYPE	FERRULE	STRIP DIMS	HEX SIZES
BN02-3002-C06-2	BT3002, TZC75024	F1	B11	H7
BN02-M059-C06	Mini RG59, 62	F1	B11	H2
BN02-0013-C06	PSF1/3	F1	B11	H4
BN02-0017-C06	PSF1/7	F1	B11	H2
BN02-3002-C06	RD179	F1	B11	H2
BN02-D316-C06	RD316	F1	B11	H2
BN02-0400-C06	RG142, 223, 400	F1	B11	H3
BN02-0174-C06	RG174, 188, 316	F2	B11	H2
BN02-0179-C06	RG179, 187	F2	B11	H2
BN02-0058-C06	RG58, URM43	F1	B11	H3
BN02-0059-C06	RG59, 62, URM70	F1	B11	H4

Strip Dimensions - see Illustration S.1

B11: A = 8.0mm B = 6.0mm C = 3.0mm

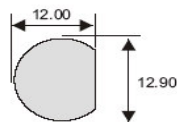

Crimp Hex Sizes:
See Page 3 for ferrule styles and crimp hex sizes.

Illustration S.1

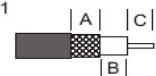

EURO RADIO SYSTEM

Tél: +33 (0)1 39 31 28 00 Fax: +33 (0)1 39 31 27 00 E-Mail: commercial@ers.fr Site: www.ers.fr

BNC Cable Fixing 5

Crimp Bulkhead Jack - Circular Flange

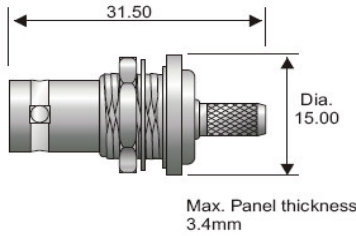

PART NUMBER	CABLE TYPE	FERRULE	STRIP DIMS	HEX SIZES
BN02-0017-C06-1	PSF1/7	F3	B12	H3
BN02-0400-C06-2	RG142, 223, 400	F1	B11	H3
BN02-0174-C06-1	RG174, 188, 316	F3	B12	H3
BN02-0179-C06-1	RG179, 187, Triple Coax	F3	B12	H3
BN02-0058-C06-2	RG58, URM43	F1	B11	H3

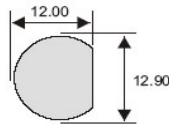

Strip Dimensions - see Illustration S.1
 B11: A = 8.0mm B = 6.0mm C = 3.0mm
 B12: A = 12.0mm B = 3.0mm C = 3.0mm

Crimp Panel Mount Jack - Front Entry

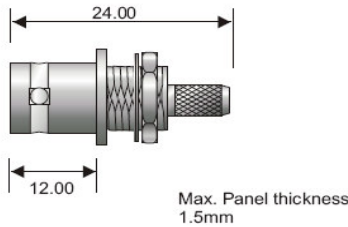

PART NUMBER	CABLE TYPE	FERRULE	STRIP DIMS	HEX SIZES
BN62-3002-C06	RD179	F1	B17	H2
BN62-D316-C06	RD316	F1	B17	H2
BN62-0400-C06	RG142, 223, 400	F1	B17	H3
BN62-0174-C06	RG174, 188, 316	F2	B17	H2
BN62-0174-C06-1	RG174, 188, 316	F3	B12	H3
BN62-0179-C06	RG179, 187	F2	B17	H2
BN62-0179-C06-1	RG179PE, Triple Coax	F3	B12	H3
BN62-0058-C06	RG58, URM43	F1	B17	H3

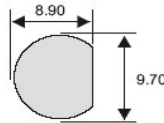

Strip Dimensions - see Illustration S.1
 B17: A = 8.0mm B = 3.0mm C = 3.0mm
 B12: A = 12.0mm B = 3.0mm C = 3.0mm

Crimp Flange Jack

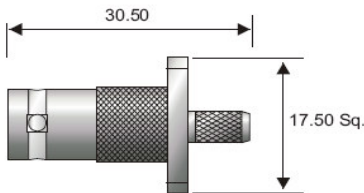

PART NUMBER	CABLE TYPE	FERRULE	STRIP DIMS	HEX SIZES
BN06-0400-C06	RG142, 223, 400	F1	B17	H3
BN06-0174-C06-1	RG174, 188, 316	F3	B12	H3
BN06-0179-C06-1	RG179, 187, RG179PE	F3	B12	H3
BN06-0058-C06	RG58, URM43	F1	B17	H3
BN06-0059-C06	RG59, 62, URM70	F1	B17	H3

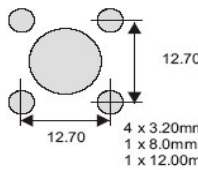

Strip Dimensions - see Illustration S.1
 B12: A = 12.0mm B = 3.0mm C = 3.0mm
 B17: A = 8.0mm B = 3.0mm C = 3.0mm

Crimp Right Angle Bulkhead Jack

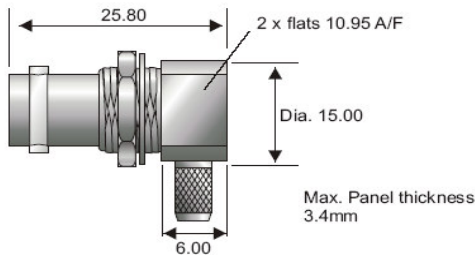

PART NUMBER	CABLE TYPE	FERRULE	STRIP DIMS	HEX SIZES
BN02-0174-C06-LP	RG174, 188, 316	F1	B11	H1
BN02-0179-C06-LP	RG179, 187, RG179PE	F1	B11	H1

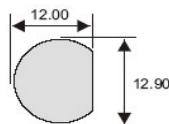

Strip Dimensions - see Illustration S.1
 B11: A = 8.0mm B = 6.0mm C = 3.0mm

Crimp Hex Sizes:
 See Page 3 for ferrule styles and crimp hex sizes.



6 BNC Cable Fixing

Clamp Plug

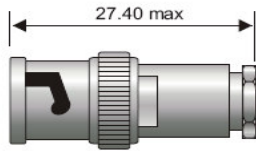

PART NUMBER	CABLE TYPE	STRIP DIMS
BN15-0400-L06	RG142, 223, 400	B18
BN15-0174-L06	RG174, 188, 316	B18
BN15-0179-L06	RG179, 187, RG179PE	B18
BN15-0058-L06	RG58, URM43	B18
BN15-0059-L06	RG59, 62, URM70	B18

Strip Dimensions - see Illustration S.2
B18: A = 8.0mm B = 5.0mm C = 3.0mm

Clamp Plug

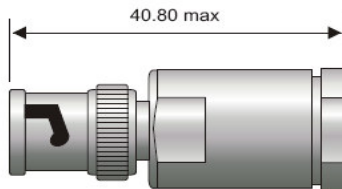

PART NUMBER	CABLE TYPE	STRIP DIMS
BN15-0213-L06	RG11, RG213	B19
BN15-0214-L06	RG214	B19

Strip Dimensions - see Illustration S.2
B19: A = 10.0mm B = 5.5mm C = 4.5mm

Twist-on Plug

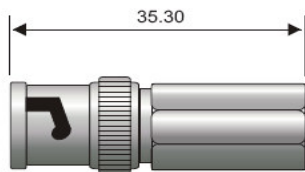

PART NUMBER	CABLE TYPE	STRIP DIMS
BN15-0100-T06	CT100	B20
BN15-0059-T06	RG59	B20

Strip Dimensions - see Illustration S.1
B20: A = 5.0mm B = 1.0mm C = 8.0mm

Twist-on Jack

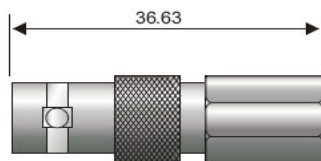

PART NUMBER	CABLE TYPE	STRIP DIMS
BN10-0100-T06	CT100	B21
BN10-0059-T06	RG59	B21

Strip Dimensions - see Illustration S.1
B21: A = 5.0mm B = 1.0mm C = 10.0mm



BNC Adaptors 7

Terminator

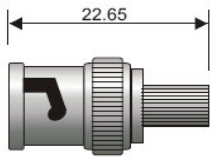

PART NUMBER	DETAILS	IMPEDANCE	RATING
BN15-50-A06	Nickel Plated	50	1/2 watt
BN15-75-A06	Nickel Plated	75	1/2 watt

Terminator with chain

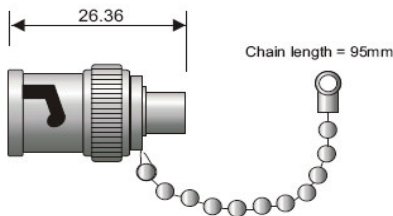

PART NUMBER	DETAILS	IMPEDANCE	RATING
BN15-50-A06-1	Nickel Plated, with chain	50	1/2 watt
BN15-75-A06-1	Nickel Plated, with chain	75	1/2 watt

Jack to Jack Adaptor

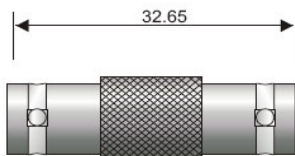

PART NUMBER	DETAILS	IMPEDANCE	DIELECTRIC
BN10-10-A06	Brass Body, Nickel Plated	50	Delrin
BN10-10-A06-1	Brass Body, Nickel Plated	75	Delrin
BN10-10-A06-2	Die-Cast Body, Nickel Plated	50	Delrin
BN10-10-A06-3	Die-Cast Body, Nickel Plated	75	Delrin
BN10-10-A06-4	Brass Body, Nickel Plated	50	PTFE
BN10-10-A06-5	Brass Body, Nickel Plated	75	PTFE

Bulkhead Jack to Jack Adaptor

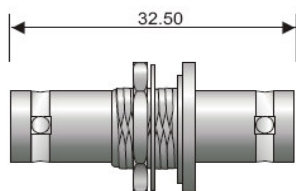

Max. Panel thickness
5.8mm

PART NUMBER	DETAILS	IMPEDANCE	DIELECTRIC
BN02-10-A06	Brass Body, Nickel Plated	50	Delrin
BN02-10-A06-1	Brass Body, Nickel Plated	75	Delrin
BN02-10-A06-2	Die-Cast Body, Nickel Plated	50	Delrin
BN02-10-A06-3	Die-Cast Body, Nickel Plated	75	Delrin
BN02-10-A06-4	Brass Body, Nickel Plated	50	PTFE
BN02-10-A06-5	Brass Body, Nickel Plated	75	PTFE

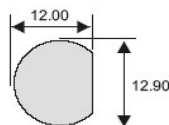

EURO RADIO SYSTEM

Tél: +33 (0)1 39 31 28 00 Fax: +33 (0)1 39 31 27 00 E-Mail: commercial@ers.fr Site: www.ers.fr

8 BNC Adaptors

Bulkhead Jack to Jack Adaptor - Insulated

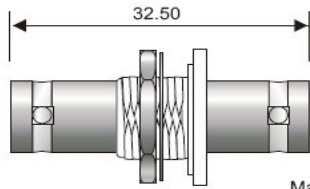

Max. Panel thickness
5.0mm

PART NUMBER	DETAILS	IMPEDANCE
BN02-10-D06	Insulated Body	50
BN02-10-D06-1	Insulated Body	75

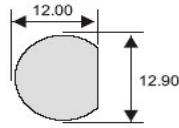

Flange Mount Bulkhead Jack to Jack

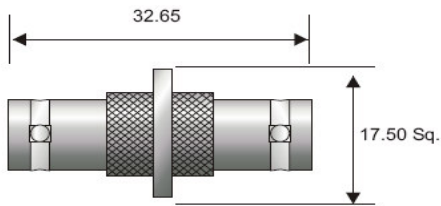

PART NUMBER	DETAILS	IMPEDANCE
BN06-10-A06	Nickel Plated	50
BN06-10-A06-1	Nickel Plated	75

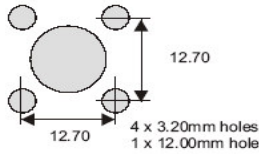

Right Angle Plug to Jack

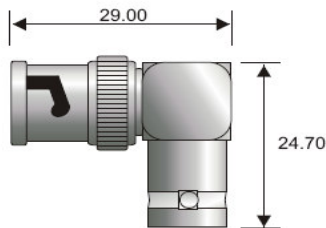

PART NUMBER	DETAILS	IMPEDANCE
BN17-10-A06	Nickel Plated	50
BN17-10-A06-1	Nickel Plated	75

Plug to Plug

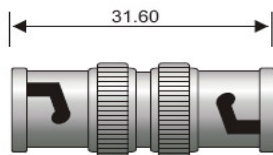

PART NUMBER	DETAILS	IMPEDANCE
BN15-15-A06	Nickel Plated	50
BN15-15-A06-1	Nickel Plated	75

EURO RADIO SYSTEM

Tél: +33 (0)1 39 31 28 00 Fax: +33 (0)1 39 31 27 00 E-Mail: commercial@ers.fr Site: www.ers.fr

BNC Adaptors 9

Jack to Plug to Jack - "T"

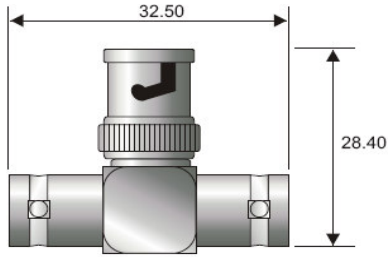

PART NUMBER	DETAILS	IMPEDANCE
BN10-1510-A06	Nickel Plated	50
BN10-1510-A06-1	Nickel Plated	75

Jack to Jack to Jack "T"

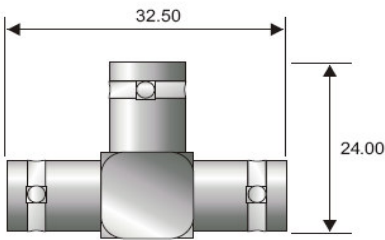

PART NUMBER	DETAILS	IMPEDANCE
BN10-1010-A06	Nickel Plated	50
BN10-1010-A06-1	Nickel Plated	75

Jack to Plug to Jack, "Goalpost"

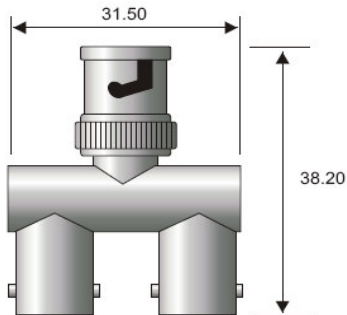

PART NUMBER	DETAILS	IMPEDANCE
BN10-1510-A06-2	Nickel Plated	50
BN10-1510-A06-3	Nickel Plated	75

Jack to Plug to Jack, "F Style"

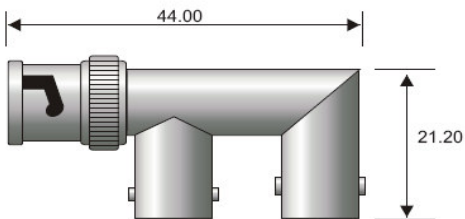

PART NUMBER	DETAILS	IMPEDANCE
BN10-1510-A06-4	Nickel Plated	50
BN10-1510-A06-5	Nickel Plated	75

EURO RADIO SYSTEM

Tél: +33 (0)1 39 31 28 00 Fax: +33 (0)1 39 31 27 00 E-Mail: commercial@ers.fr Site: www.ers.fr

10 BNC Panel and PCB Mounting

Panel Jack - Solder Receptacle

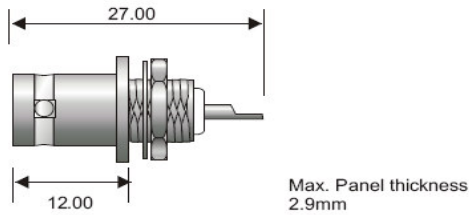

PART NUMBER	DETAILS	IMPEDANCE	DIELECTRIC
BN62-X001-N06	Nickel Plated	50	Delrin
BN62-X001-N06-1	Nickel Plated	75	Delrin
BN62-X001-N06-2	Nickel Plated	50	PTFE
BN62-X001-N06-3	Nickel Plated	75	PTFE

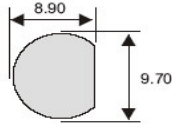

Panel Jack - Solder Receptacle, Long Barrel

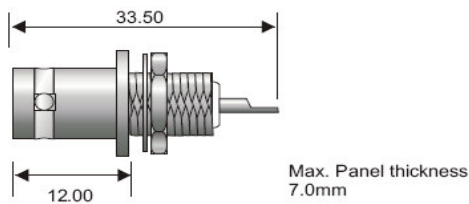

PART NUMBER	DETAILS	IMPEDANCE	DIELECTRIC
BN62-X001-N06-4	Nickel Plated	50	Delrin
BN62-X001-N06-5	Nickel Plated	75	Delrin
BN62-X001-N06-6	Nickel Plated	50	PTFE
BN62-X001-N06-7	Nickel Plated	75	PTFE

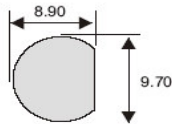

Insulated Panel Jack - Solder Receptacle

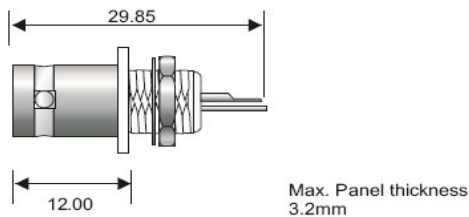

PART NUMBER	DETAILS	IMPEDANCE	DIELECTRIC
BN62-X001-D06	Nickel Plated	50	Delrin
BN62-X001-D06-1	Nickel Plated	75	Delrin
BN62-X001-D06-2	Nickel Plated	50	PTFE
BN62-X001-D06-3	Nickel Plated	75	PTFE

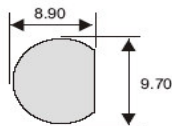

Flange Panel Jack, Solder Receptacle

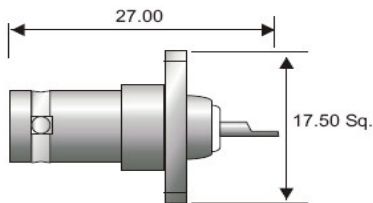

PART NUMBER	DETAILS	IMPEDANCE	DIELECTRIC
BN06-X001-N06	Nickel Plated	50	Delrin
BN06-X001-N06-1	Nickel Plated	75	Delrin
BN06-X001-N06-2	Nickel Plated	50	PTFE
BN06-X001-N06-3	Nickel Plated	75	PTFE

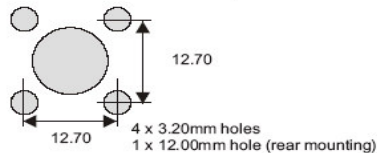

BNC Panel and PCB Mounting 11

Panel Plug Solder Receptacle

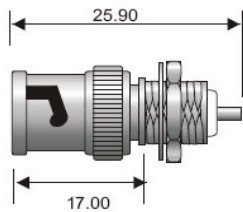

Max. Panel thickness
2.9mm

PART NUMBER	DETAILS	IMPEDANCE	DIELECTRIC
BN15-X001-N06	Nickel Plated	50	Delrin
BN15-X001-N06-1	Nickel Plated	75	Delrin

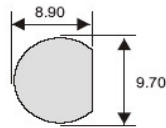

Vertical PCB Jack, Square Base

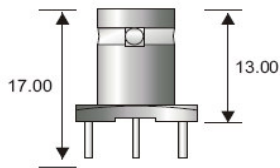

PART NUMBER	DETAILS	IMPEDANCE	DIELECTRIC
BN10-X150-N06-4	Nickel Plated	50	PTFE
BN10-X150-N06-5	Nickel Plated	75	PTFE

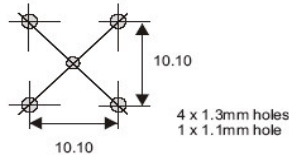

Vertical PCB Jack

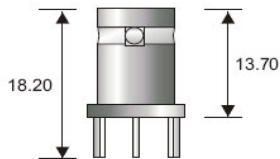

PART NUMBER	DETAILS	IMPEDANCE	DIELECTRIC
BN10-X150-N06	Nickel Plated	50	PTFE
BN10-X150-N06-1	Nickel Plated	75	PTFE
BN10-X150-N08	Silver Plated	50	PTFE
BN10-X150-N08-1	Silver Plated	75	PTFE
BN10-X150-N11	Tin Plated	50	PTFE
BN10-X150-N11-1	Tin Plated	75	PTFE

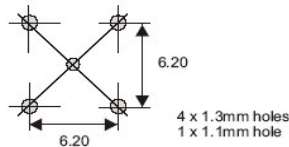

Vertical PCB Jack

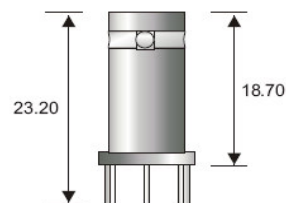

PART NUMBER	DETAILS	IMPEDANCE	DIELECTRIC
BN10-X150-N06-2	Nickel Plated	50	PTFE
BN10-X150-N06-3	Nickel Plated	75	PTFE
BN10-X150-N08-2	Silver Plated	50	PTFE
BN10-X150-N08-3	Silver Plated	75	PTFE
BN10-X150-N11-2	Tin Plated	50	PTFE
BN10-X150-N11-3	Tin Plated	75	PTFE

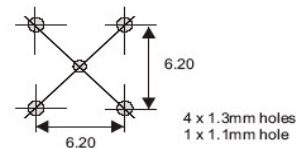

EURO RADIO SYSTEM

Tél: +33 (0)1 39 31 28 00 Fax: +33 (0)1 39 31 27 00 E-Mail: commercial@ers.fr Site: www.ers.fr

12 BNC Panel and PCB Mounting

Insulated Right Angle PCB Jack

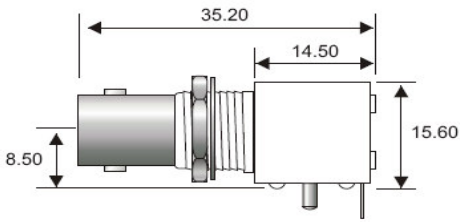

PART NUMBER	DETAILS	IMPEDANCE	DIELECTRIC
BN02-X170-N06	White Insulated Body	50	Delrin
BN02-X170-N06-1	White Insulated Body	75	Delrin
BN02-X171-N06	Black Insulated Body	50	PTFE
BN02-X171-N06-1	Black Insulated Body	75	PTFE

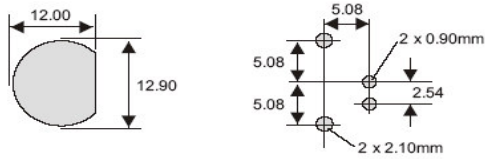

Insulated Right Angle PCB Jack - Low Profile

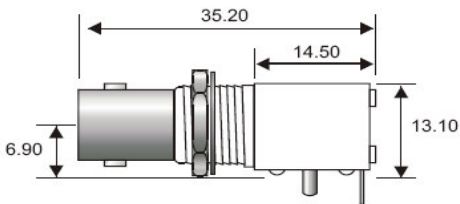

PART NUMBER	DETAILS	IMPEDANCE	DIELECTRIC
BN02-X170-N06-2	White Insulated Body	50	Delrin
BN02-X170-N06-3	White Insulated Body	75	Delrin
BN02-X171-N06-2	Black Insulated Body	50	PTFE
BN02-X171-N06-3	Black Insulated Body	75	PTFE

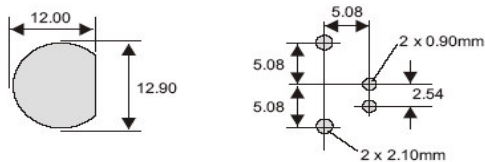

Insulated Vertical PCB Jack

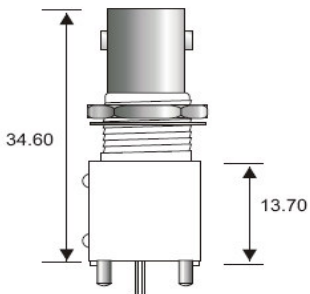

PART NUMBER	DETAILS	IMPEDANCE	DIELECTRIC
BN02-X180-N06	White Insulated Body	50	Delrin
BN02-X180-N06-1	White Insulated Body	75	Delrin
BN02-X181-N06	Black Insulated Body	50	PTFE
BN02-X181-N06-1	Black Insulated Body	75	PTFE

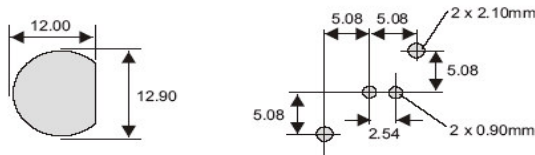

Shielded Right Angle PCB Jack

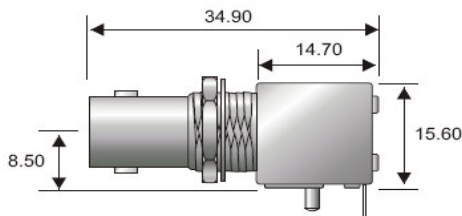

PART NUMBER	DETAILS	IMPEDANCE	DIELECTRIC
BN02-X600-N06	Nickel Plated	50	Delrin
BN02-X600-N06-1	Nickel Plated	75	Delrin
BN02-X601-N06	Nickel Plated	50	PTFE
BN02-X601-N06-1	Nickel Plated	75	PTFE

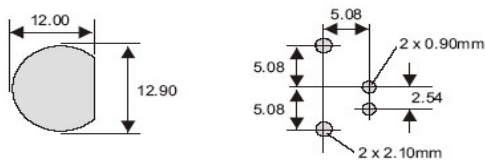

EURO RADIO SYSTEM

Tél: +33 (0)1 39 31 28 00 Fax: +33 (0)1 39 31 27 00 E-Mail: commercial@ers.fr Site: www.ers.fr

BNC Panel and PCB Mounting 13

Shielded Right Angle PCB Jack - Low Profile

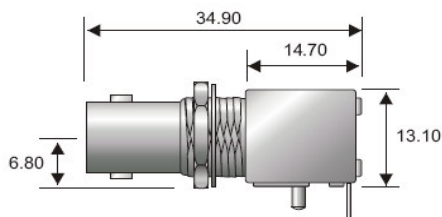

PART NUMBER	DETAILS	IMPEDANCE	DIELECTRIC
BN02-X600-N06-2	Nickel Plated	50	Delrin
BN02-X600-N06-3	Nickel Plated	75	Delrin
BN02-X601-N06-2	Nickel Plated	50	PTFE
BN02-X601-N06-3	Nickel Plated	75	PTFE

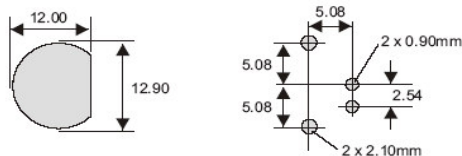

Shielded Vertical PCB Jack

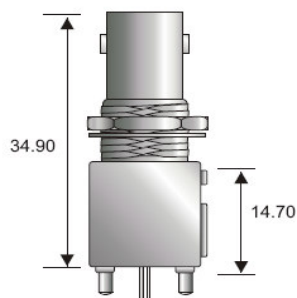

PART NUMBER	DETAILS	IMPEDANCE	DIELECTRIC
BN02-X150-N06	Nickel Plated	50	Delrin
BN02-X150-N06-1	Nickel Plated	75	Delrin
BN02-X151-N06	Nickel Plated	50	PTFE
BN02-X151-N06-1	Nickel Plated	75	PTFE

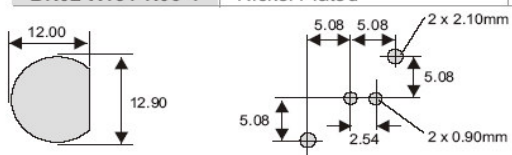

Shielded Right Angle PCB Jack, Extra Low Profile

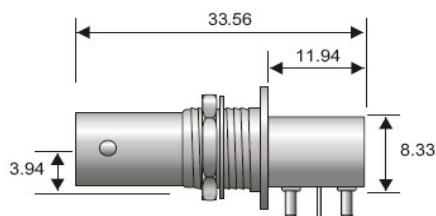

PART NUMBER	DETAILS	IMPEDANCE	DIELECTRIC
BN02-X600-N11-4	Tin Plated	50	Delrin
BN02-X600-N11-5	Tin Plated	75	Delrin
BN02-X601-N11-4	Tin Plated	50	PTFE
BN02-X601-N11-5	Tin Plated	75	PTFE
BN02-X600-N06-4	Nickel Plated	50	Delrin
BN02-X600-N06-5	Nickel Plated	75	Delrin
BN02-X601-N06-4	Nickel Plated	50	PTFE
BN02-X601-N06-5	Nickel Plated	75	PTFE

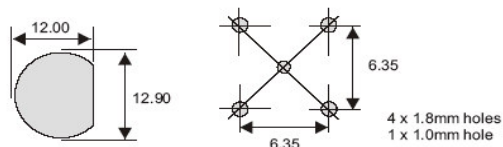

14 BNC Panel and PCB Mounting

Filtered Right Angle PCB Jack

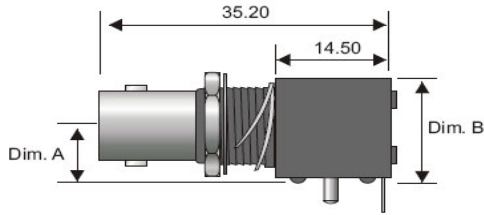

PART NUMBER	DETAILS	IMPEDANCE	DIELECTRIC
BN02-X300-N06	Dim A = 8.50, Dim B = 15.80	50	Delrin
BN02-X300-N06-1	Dim A = 8.50, Dim B = 15.80	75	Delrin
BN02-X300-N06-2	Dim A = 6.90, Dim B = 13.00	50	Delrin
BN02-X300-N06-3	Dim A = 6.90, Dim B = 13.00	75	Delrin

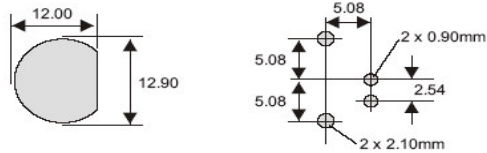

Filtered Vertical PCB Jack

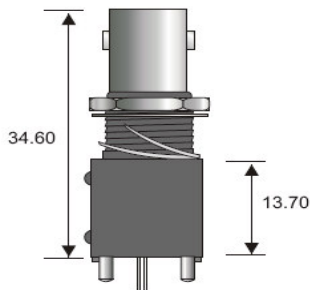

PART NUMBER	DETAILS	IMPEDANCE	DIELECTRIC
BN02-X310-N06	Black Insulated Body	50	Delrin
BN02-X310-N06-1	Black Insulated Body	75	Delrin

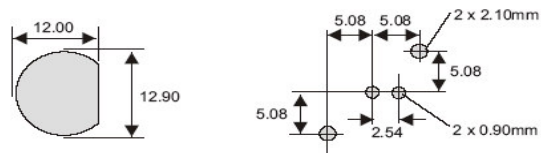

Right Angle Double PCB Jack

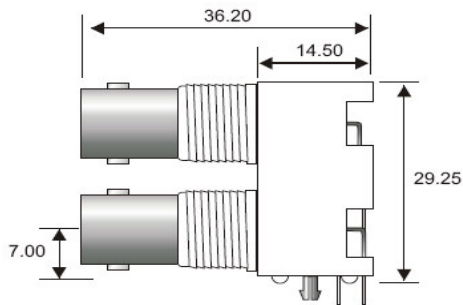

PART NUMBER	DETAILS	IMPEDANCE	DIELECTRIC
BN02-X800-N06	White Insulated Body	50	Delrin
BN02-X800-N06-1	White Insulated Body	75	Delrin
BN02-X900-N06	Shielded Body	50	Delrin
BN02-X900-N06-1	Shielded Body	75	Delrin

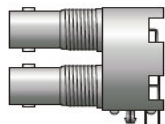
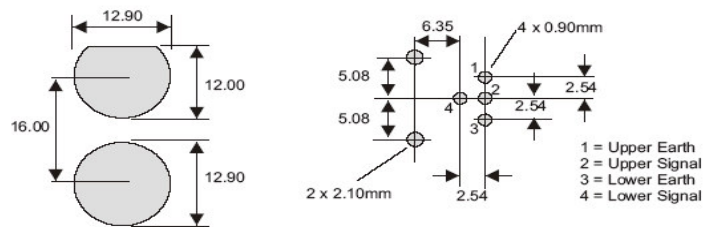

Also available with shielded / nickel plated body. See part number box for details.

EURO RADIO SYSTEM

Tél: +33 (0)1 39 31 28 00 Fax: +33 (0)1 39 31 27 00 E-Mail: commercial@ers.fr Site: www.ers.fr