

40 SMB Specifications

SMB Plug



SMB Jack



ELECTRICAL

Impedance	50 ohms	75 ohms
Frequency	DC to 4GHz	DC to 2GHz
VSWR	1.25 + 0.04f(GHz) Straight 1.30 + 0.04f(GHz) Right Angle	1.25 + 0.04f(GHz) Straight 1.30 + 0.04f(GHz) Right Angle
Insertion Loss	0.4dB (Straight) 0.6dB (Right Angle)	0.4dB (Straight) 0.6dB (Right Angle)
RF Leakage	-55dB Minimum	-55dB Minimum
Insulation Resistance	1Gohms Minimum	1Gohms Minimum
Inner Contact Resistance	6mohms Maximum	6mohms Maximum
Outer Contact Resistance	1mohms Maximum	1mohms Maximum
Working Voltage	335V RMS	335V RMS
Dielectric Withstanding Voltage	750V RMS	750V RMS

MECHANICAL

Durability	500 mating cycles	500 mating cycles
Cable Retention	Equal to cable breaking strain	

ENVIRONMENTAL

Temperature Range	-65 to +165 degrees centigrade	-65 to +165 degrees centigrade
-------------------	--------------------------------	--------------------------------

MATERIALS

Bodies	Brass, Gold or Nickel Plated	Brass, Gold or Nickel Plated
Pins	Brass, Gold Plated	Brass, Gold or Nickel Plated
Contacts	Beryllium Copper, Gold Plated	Beryllium Copper, Gold Plated
Ferrules	Brass, Gold or Nickel Plated	Brass, Gold or Nickel Plated
Insulators	PTFE	PTFE
End Caps	Brass, Gold or Nickel Plated	Brass, Gold or Nickel Plated
Gaskets	Silicon Rubber	Silicon Rubber
Panel Nuts	Brass, Gold or Nickel Plated	Brass, Gold or Nickel Plated
Panel Washers	Brass, Gold or Nickel Plated	Brass, Gold or Nickel Plated

All of the above products are manufactured in accordance with MIL-C-39012.

The above specifications are typical although some variations may occur.

EURO RADIO SYSTEM

Tél: +33 (0)1 39 31 28 00 Fax: +33 (0)1 39 31 27 00 E-Mail: commercial@ers.fr Site: www.ers.fr

SMB Cable Fixing 41

Crimp Plug

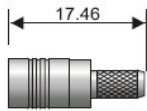

PART NUMBER	CABLE TYPE		STRIP DIMS		HEX SIZES	
MB15-3002-C01	BT3002	Gold	S15	H8		
MB15-3002-C01-Z	BT3002	Gold	S15	H8		
MB15-D179-C01	RD179	Gold	S15	H8		
MB15-D179-C06	RD179	Nickel	S15	H8		
MB15-D179-C01-Z	RD179	Gold	S15	H8		
MB15-D179-C06-Z	RD179	Nickel	S15	H8		
MB15-D316-C01	RD316	Gold	S15	H8		
MB15-D316-C06	RD316	Nickel	S15	H8		
MB15-0174-C01	RG174, 188, 316	Gold	S15	H1		
MB15-0174-C06	RG174, 188, 316	Nickel	S15	H1		
MB15-0179-C01	RG179, 187	Gold	S15	H1		
MB15-0179-C06	RG179, 187	Nickel	S15	H1		
MB15-0179-C01-Z	RG179, 187	Gold	S15	H1		
MB15-0179-C06-Z	RG179, 187	Nickel	S15	H1		

CRIMP HEX SIZES (ferrule / contact)

H1	3.25mm	0.72mm sq.
H8	3.83mm	0.72mm sq.

Strip Dimensions - see Illustration S.1

S15: A = 5.0mm B = 3.5mm C = 2.5mm

See pages 85-86 for application tooling

Illustration S.1

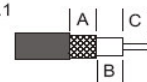

Crimp Right Angle Plug

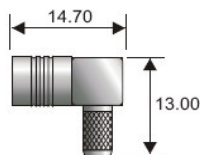

PART NUMBER	CABLE TYPE		STRIP DIMS		HEX SIZES	
MB17-3002-C01	BT3002	Gold	S16	H8		
MB17-3002-C01-Z	BT3002	Gold	S16	H8		
MB17-D179-C01	RD179	Gold	S16	H8		
MB17-D179-C06	RD179	Nickel	S16	H8		
MB17-D179-C01-Z	RD179	Gold	S16	H8		
MB17-D179-C06-Z	RD179	Nickel	S16	H8		
MB17-D316-C01	RD316	Gold	S16	H8		
MB17-D316-C06	RD316	Nickel	S16	H8		
MB17-0174-C01	RG174, 188, 316	Gold	S16	H1		
MB17-0174-C06	RG174, 188, 316	Nickel	S16	H1		
MB17-0179-C01	RG179, 187	Gold	S16	H1		
MB17-0179-C06	RG179, 187	Nickel	S16	H1		
MB17-0179-C01-Z	RG179, 187	Gold	S16	H1		
MB17-0179-C06-Z	RG179, 187	Nickel	S16	H1		

Strip Dimensions - see Illustration S.1

S16: A = 4.5mm B = 4.0mm C = 1.5mm

EURO RADIO SYSTEM

Tél: +33 (0)1 39 31 28 00 Fax: +33 (0)1 39 31 27 00 E-Mail: commercial@ers.fr Site: www.ers.fr

42 SMB Cable and Panel Fixing

Crimp Jack

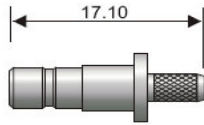

PART NUMBER	CABLE TYPE		STRIP DIMS		HEX SIZES	
MB10-D179-C01	RD179	Gold	S18	H8		
MB10-D179-C06	RD179	Nickel	S18	H8		
MB10-D179-C01-Z	RD179	Gold	S18	H8		
MB10-D179-C06-Z	RD179	Nickel	S18	H8		
MB10-D316-C01	RD316	Gold	S18	H8		
MB10-D316-C06	RD316	Nickel	S18	H8		
MB10-0174-C01	RG174, 188, 316	Gold	S18	H1		
MB10-0174-C06	RG174, 188, 316	Nickel	S18	H1		
MB10-0179-C01	RG179, 187	Gold	S18	H1		
MB10-0179-C06	RG179, 187	Nickel	S18	H1		
MB10-0179-C01-Z	RG179, 187	Gold	S18	H1		
MB10-0179-C06-Z	RG179, 187	Nickel	S18	H1		

Strip Dimensions - see Illustration S.1
S18: A = 5.0mm B = 3.5mm C = 2.5mm

Crimp Bulkhead Jack

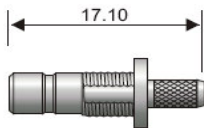

Max. Panel Thickness 2.4mm

PART NUMBER	CABLE TYPE		STRIP DIMS		HEX SIZES	
MB02-D179-C01	RD179	Gold	S18	H8		
MB02-D179-C06	RD179	Nickel	S18	H8		
MB02-D179-C01-Z	RD179	Gold	S18	H8		
MB02-D179-C06-Z	RD179	Nickel	S18	H8		
MB02-D316-C01	RD316	Gold	S18	H8		
MB02-D316-C06	RD316	Nickel	S18	H8		
MB02-0174-C01	RG174, 188, 316	Gold	S18	H1		
MB02-0174-C06	RG174, 188, 316	Nickel	S18	H1		
MB02-0179-C01	RG179, 187	Gold	S18	H1		
MB02-0179-C06	RG179, 187	Nickel	S18	H1		
MB02-0179-C01-Z	RG179, 187	Gold	S18	H1		
MB02-0179-C06-Z	RG179, 187	Nickel	S18	H1		

Strip Dimensions - see Illustration S.1
S18: A = 5.0mm B = 3.5mm C = 2.5mm

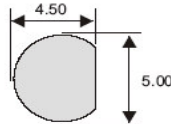

Panel Mount Jack

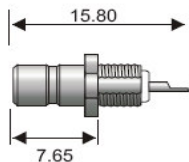

Max. Panel Thickness 2.4mm

PART NUMBER	DETAILS	PLATING
MB62-X001-N01	50 ohms	Gold
MB62-X001-N06	50 ohms	Nickel

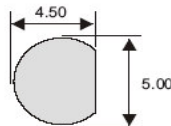
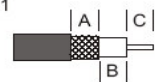

Illustration S.1



EURO RADIO SYSTEM

Tél: +33 (0)1 39 31 28 00 Fax: +33 (0)1 39 31 27 00 E-Mail: commercial@ers.fr Site: www.ers.fr

SMB Panel and PCB Mounting 43

Bulkhead Jack to Jack

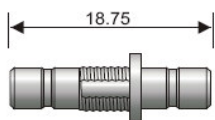

PART NUMBER	DETAILS	PLATING
MB02-10-A01	50 ohms	Gold
MB02-10-A01-Z	75 ohms	Gold

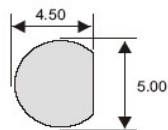

Vertical Jack

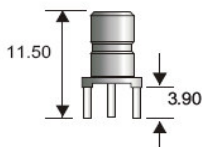

PART NUMBER	DETAILS	PLATING
MB10-X150-N01	50 ohms	Gold
MB10-X150-N01-Z	75 ohms	Gold

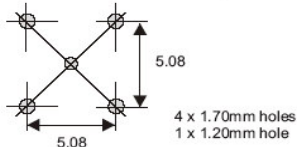

Right Angle Jack

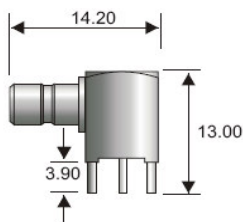

PART NUMBER	DETAILS	PLATING
MB10-X170-N01	50 ohms	Gold
MB10-X170-N01-Z	75 ohms	Gold

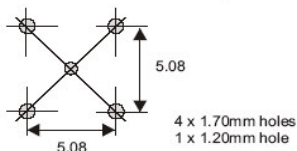

Vertical Plug

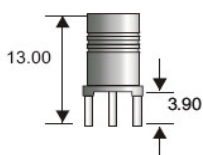

PART NUMBER	DETAILS	PLATING
MB15-X150-N01	50 ohms	Gold
MB15-X150-N01-Z	75 ohms	Gold

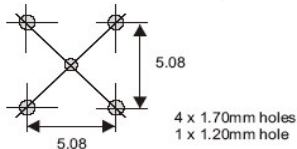

Right Angle Plug

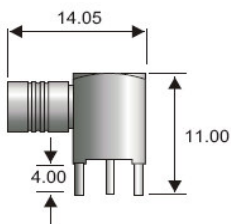

PART NUMBER	DETAILS	PLATING
MB15-X170-N01	50 ohms	Gold
MB15-X170-N01-Z	75 ohms	Gold

